



230 East Superior Street, Duluth  
The Intrepid Building, Lower Level

# SPACE FOR LEASE

## Contact:



218.461.4344



info@titaniumpartners.com



titaniumpartners.com

**TITANIUM**  
PARTNERS



## Unique Commercial Space for Lease – Prime Downtown Duluth Location

Discover a versatile and affordable space in the heart of Duluth's vibrant HART (Historic Arts & Theater) District. The lower level of the Intrepid Building offers two available suites perfect for a variety of businesses – from wellness studios and creative workspaces to boutique services or storage. This space is ideal for businesses that thrive with a built-in clientele or don't rely heavily on walk-in traffic.

Whether you're expanding your business or launching something new, this unique and affordable space offers the flexibility and location to make it your own.

Schedule a tour today and see how your business could thrive at the Intrepid Building.

## Features

- Private entrances for each suite
- Shared restrooms on the lower level
- Flexible lease terms - short- and long-term options available
- Located near Essentia Health Campus and Greysolon by Black Woods
- Great opportunity in a high-demand downtown district

## Available Spaces

**Space A: Approx. 1,300 sq ft**  
Rate: \$15/sq ft Gross  
Ideal for: Storage or creative workspace

**Space B: Approx. 1,750 sq ft**  
Rate: \$20/sq ft Gross  
Ideal for: Salon and/or massage studio, yoga or dance studio, boutique fitness, florist or other specialized services

230 East Superior Street, Duluth, MN

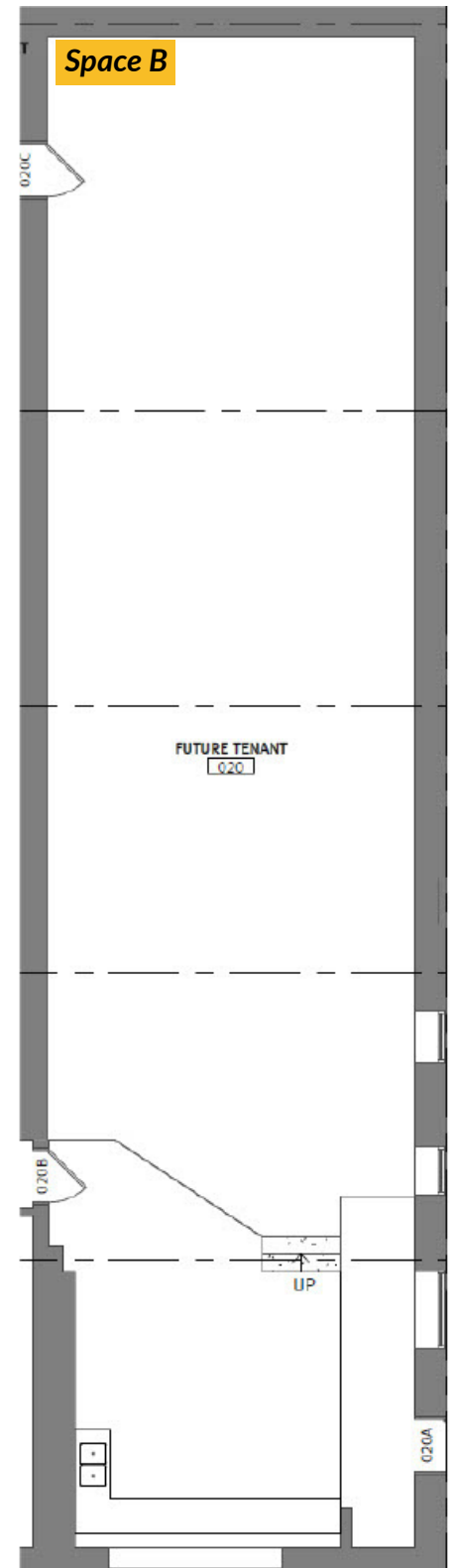
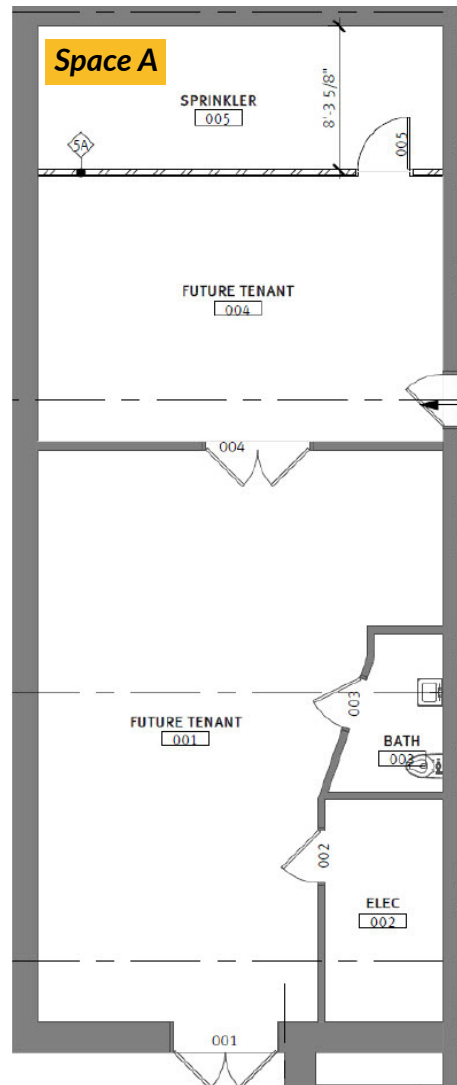

To learn more about  
this space, contact:

**TITANIUM**

PARTNERS

218.461.4344 | [info@titaniumpartners.com](mailto:info@titaniumpartners.com)  
[titaniumpartners.com](http://titaniumpartners.com)